



© Lauri Hokkinen

19M Work and Oil recovery vessel

Description

This handy size Work and Oil recovery vessel was built for the Finnish government in 1987 and have until past years served as a fairway maintenance vessel among the coastline of Finland.

Today she holds a trading licence on open sea (Traficom, Domestic III) limited to the Finnish territorial waters.

She's equipped with oil recovery booms and belt skimmers. The storage tank holds a capacity of 33 m³. Under the work deck also a cargo hold with work shop and storage for equipment. She's also equipped with a FiFi-monitor with possibility to use as a foam canon.

Her deck cranes are in good condition but not as per today classed. This has to be done prior taken them in to operation. However, this can be done at the Shipyard where she's right now.

Due to her pod drive she's highly manoeuvrable

and suitable for port operations or ship to ship operations. Also suitable for loading cargo over the bow ramp. Crew quarters with two cabins for 3 persons. Office and additional bunk bed in the wheelhouse for 1 crew member.

Considering her age, she's very well kept and equipped. At the moment dry docked at Suomenlahden Telakka in the Gulf of Finland. Where she will stay at the yard till March 2024.

Sold as surplus from current owner on "As is where is" conditions, with valid certificates.

Transport sailing from Finland to ports in North Europe can be arranged through our office.

Built acc. to Lloyd Register with following Small Craft Class notation: **✕ 100A1 Oil Recovery Ship, Extended Protected Waters Service, LMC**

Do not hesitate to ask for more information.

Specifications

Vessel type:	Oil recovery vessel	Beam:	6,5 mtr
Speed:	Abt. 9 kts	Maximum draft:	Abt. 2 mtr
Builder:	Larsen Marin Ab, FIN	GT/NT:	71/22
Class:	Traficom, III (Open sea)	LW:	78 t
Constructed:	1987	Fuel capacity:	6.600 lts
Engine model:	Scania V8 DS 14 40 ODO 10.532 hrs	Deck cargo:	Abt. 17 t
Engine power:	268 kW	Free deckspace:	Abt. 35 m ²
Fuel type:	Diesel	Max Payload:	15 KN/m ²
Drive type:	Pod drive	Crew:	2 + 12 pax
Length over all:	19,10 mtr	Generator:	31,3 kVA, 12.031 hrs

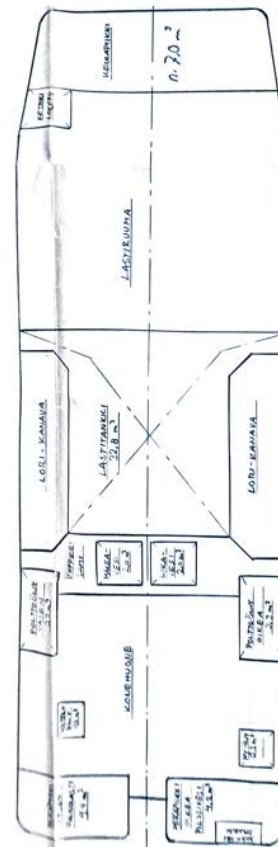
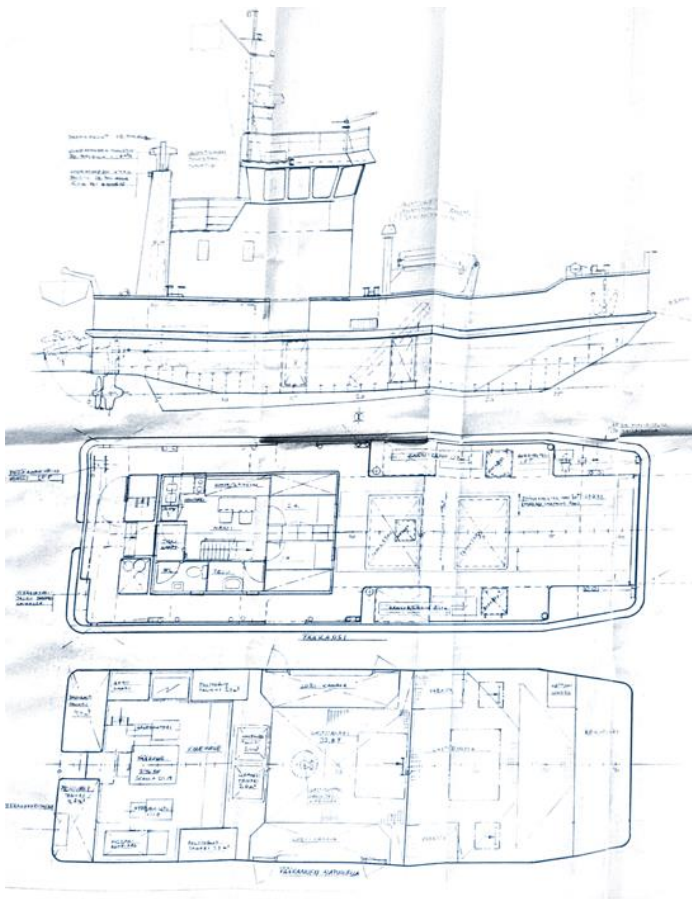



Photos from DD 19.dec 2023





360 TURING POD



REINFORCED BOW



OIL RECOVERY BELT SKIMMER (PS SIDE)



OIL RECOVERY EQUIPMENT



PORT DECK CRANE



STBD DECK CRANE





CLEAN AND WELL MAINTAINED ENGINE ROOM









Ask for more photos and survey report!

Gustav Ramberg
+358 (0)400 417 149
office@nyss.fi